

## Overland - Zone D-4

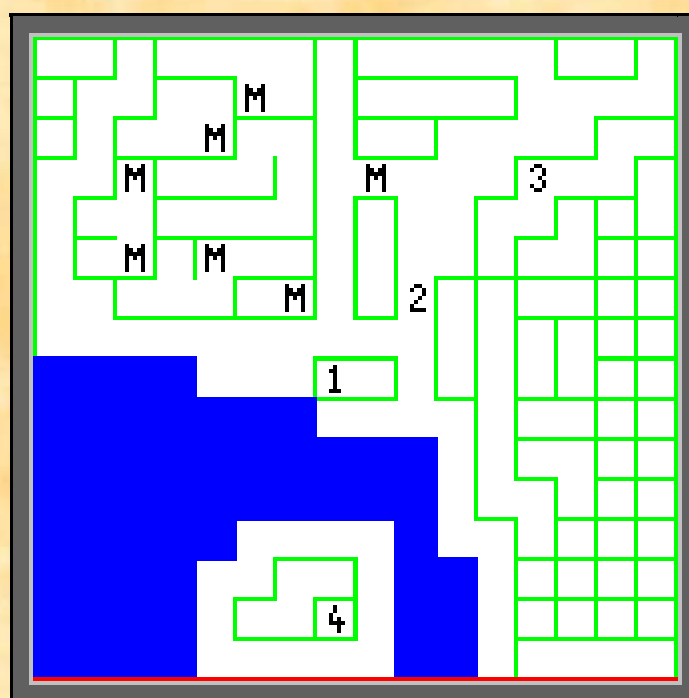

- 1) Entrée de la Ville de "Algary", position 1.
  - 2) **Great Winged Beast**, (quête 36).
  - 3) **Paul Pead**.
  - 4) Si vous ne portez pas les "B Queen Idol" et "W Queen Idol", Og vous renvoie à "Algary."
- M) Monstres.

## Algary

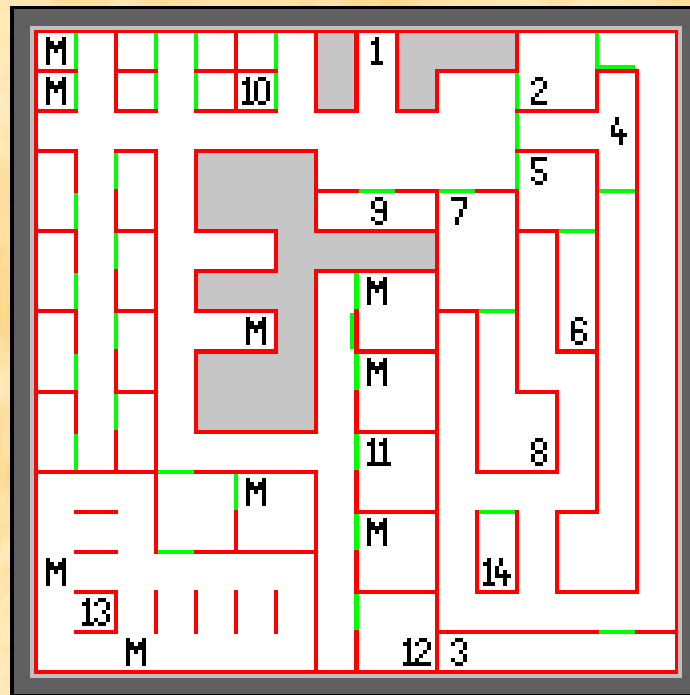

- 1) Sortie
- 2) Arcon`s Slop.
- 3) Portail vers "Overland – Zone B-1".
- 4) Etable de Algary.
- 5) Swampside Supplies.
- 6) Note: "Zom 1,1".
- 7) Dragon`s Claw Training.
- 8) Porrtail vers la prison de "Sorpigal".
- 9) Temple Half-Dead.
- 10) Morango The Mystic.
- 11) Jolly Jester Tavern.
- 12) Portail vers la ville de "Portsmith".
- 13) ZOM. "My clue is 1 - 15" or "You are not the couriers."
- 14) Portail vers le donjon "The Fabled Building of Gold, Level 1", position 1.